

REV.	ECN.NO.	MODIFY.CONTENT	DATE
A		FIRST VERSION	06/05'19

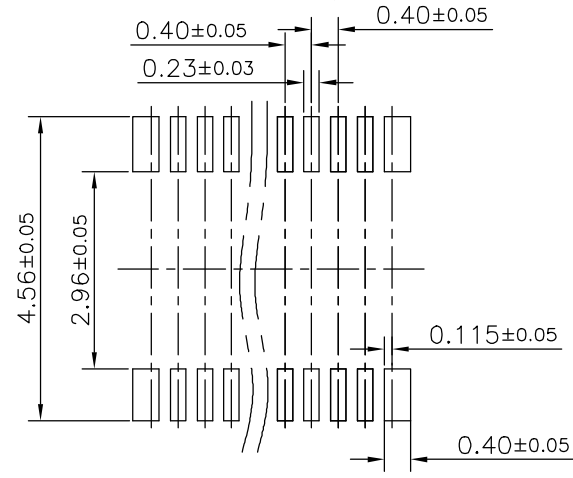
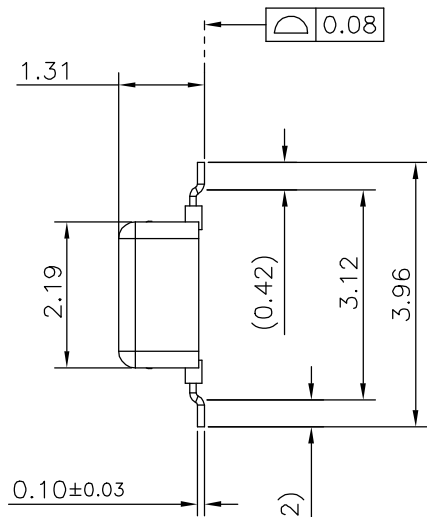
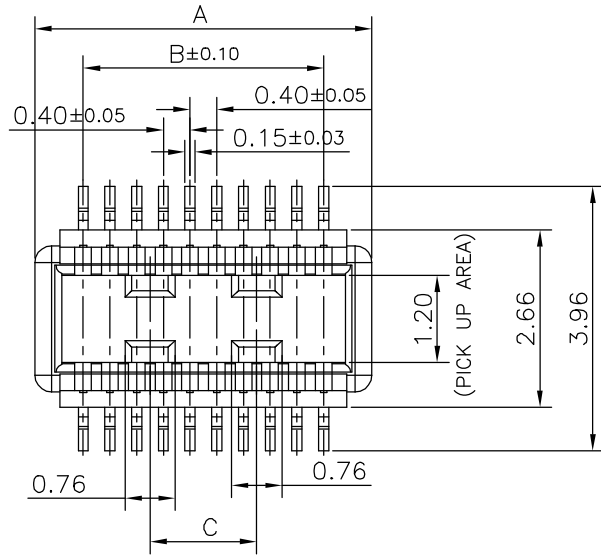

RECOMMEND PCB LAYOUT  
 DEFAULT TOL:±0.05

P/N	PIN	A	B	C
1B0418PF20D13-HF	20	5.05	3.60	1.60
1B0418PF22D13-HF	22	5.45	4.00	2.00
1B0418PF24D13-HF	24	5.85	4.40	2.40
1B0418PF26D13-HF	26	6.25	4.80	2.80
1B0418PF28D13-HF	28	6.65	5.20	3.20
1B0418PF30D13-HF	30	7.05	5.60	3.60
1B0418PF34D13-HF	34	7.85	6.40	4.40
1B0418PF36D13-HF	36	8.25	6.80	4.80
1B0418PF38D13-HF	38	8.65	7.20	5.20
1B0418PF40D13-HF	40	9.05	7.60	5.60
1B0418PF42D13-HF	42	9.45	8.00	6.00
1B0418PF44D13-HF	44	9.85	8.40	6.40
1B0418PF50D13-HF	50	11.05	9.60	7.60
1B0418PF54D13-HF	54	11.85	10.40	8.40
1B0418PF60D13-HF	60	13.05	11.60	9.60
1B0418PF64D13-HF	64	13.85	12.40	10.40
1B0418PF70D13-HF	70	15.05	13.60	11.60
1B0418PF80D13-HF	80	17.05	15.60	13.60
1B0418PF90D13-HF	90	19.05	17.60	15.60
1B0418PF1AD13-HF	100	21.05	19.60	17.60

NOTES:  
 Housing: LCP (Color: BLACK) UL 94V-0  
 Terminal: BRASS,Gold Flash plating on contact area and solder area over Ni 30~150u"  
 Current Rating: 0.3A/PIN (The total current of all PIN Numbers lower than 5A)  
 Voltage Rating: 60V DC/AC Max  
 Temperature Range: -55°C~+85°C  
 Contact Resistance: 70 mΩ Max  
 Insulation Resistance: 1000 MΩ Min(Initial),100 MΩ(After test)  
 Withstanding Voltage: 150V AC/minute  
 Insertion Force: 0.981N\*no.of pin Max(Initial)  
 Withdrawal Force: 0.0588N\*no.of pin Min  
 Durability: 50 cycles  
 PART NUMBER DESCRIPTION:

1B0418PF\*\*D13-HF  
 F: PLATING G/F REEL PACKING  
 PIN NO. 1: BLACK  
 20=20PIN  
 24=24PIN D: Rectangular SMT  
 30=30PIN  
 .....  
 1A=100PIN

GENERAL TOLERANCE		DRAWN	Wilson Sun	2019.06.05	SCALE	PART NO.	1B0418PF20D13-HF
X.±0.30	x.*±3.0'	CHECKED	/	/	1/1	TITLE	0.4 PITCH BTB PLUG
.X±0.25	.x'±2.0'	APPROVED	Cunfa Lai	2019.06.05	UNITS	mm	CUSTOMER DRAWING
.XX±0.20		File NO.	B0418P01S				
.XXX±0.10		REV.	蘇州祥龍嘉業電子科技股份有限公司 Goldenconn Electronics Technology Co.,LTD				
SHEET	1/1	Q'TY	1	A			

此文件为双方检验的唯一标准  
 This document is the only standard for inspection by both parties.